

4 QT DROP-IN SINAQUA™ SOUPER



PERFORMANCE

The SinAqua™ Souper is a drop-in countertop unit from CookTek used for rethermalizing food and precision holding. Employing a forward-thinking design and high-contrast, easy-to-use capacitive touch control, the SinAqua™ Souper can take liquid foods from an unfrozen, chilled state through the food safety danger zone in as little as 45 minutes.† After rethermalization, food is held at a precise temperature within a selectable range of 140–200 °F (60–95 °C). Utilizing CookTek inductive heating technology, the SinAqua™ Souper consistently heats food without scorching and holds food twice as long as steam wells, while using less than half the energy. The SinAqua™ Souper eliminates maintenance and plumbing associated with traditional soup warmers.

†Requires stirring

FEATURES

- SinAqua™ (waterless) holding and rethermalization
- 400 watts induction heating
- User-selectable precision hold and rethermalization functions
- Operate up to six units with a single controller
- Holding temperatures range from 140–200 °F (60–95 °C)
- Rethermalizing temperatures range from 170–200 °F (75–95 °C)
- Programmable stir notification, defaults to four minutes when rethermalizing and 15 minutes when holding
- Pan compensation technology allows for use with magnetic and non-magnetic soup tureens^{††}
- Active dry-pan protection prevents users from unintentionally damaging the unit
- Highly visible and durable capacitive touch user interface
- Audible and visual cues
- Spun aluminum exterior construction with high-gloss polycarbonate adapter ring (stainless steel adapter ring sold separately)

STANDARD INCLUDED ACCESSORIES

- 6-ft (1.8 m) nominal plug and cord
- One-year limited warranty (U.S. and Canada only)
- One 4 qt 18/8 stainless steel soup tureen and lid for maximum performance, durability, and corrosion resistance
- 6 ft 5-pin micro-USB patch cable from unit to control box

OPTIONAL ACCESSORIES

- 4 qt 18/8 stainless steel soup tureen with lid (#302478)



††The SinAqua Soupers are designed to be used exclusively with CookTek-specific tureens and lids.

It is the owner and installer's responsibility to comply with all local codes. CookTek reserves the right to substitute components or change specifications without prior notice.

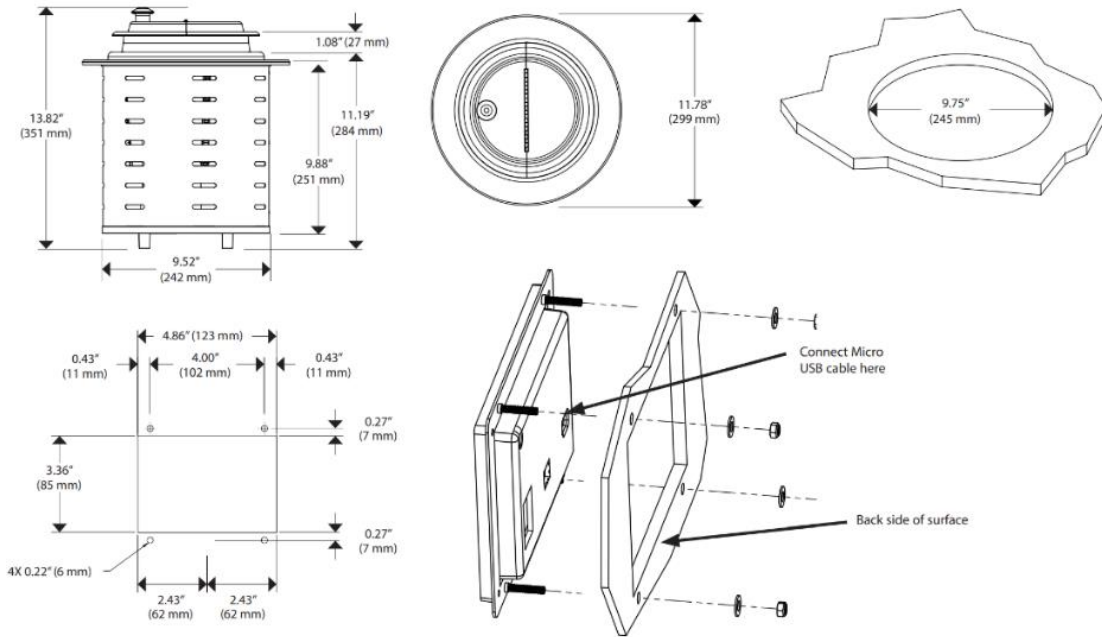

DIMENSIONS		
Unit Height	13.88"	352 mm
Diameter (overhang)	11.78"	299 mm
Cutout Diameter	9.75"	248 mm
Weight	9.75 lb	4.4 kg
Max Ambient Temperature	131 °F	55 °C

SHIPPING INFORMATION		
Packaged Height	15"	381 mm
Packaged Width	14"	356 mm
Packaged Depth	14"	356 mm
Packaged Weight	13 lb	5.9 kg
Item Class	1405001104	

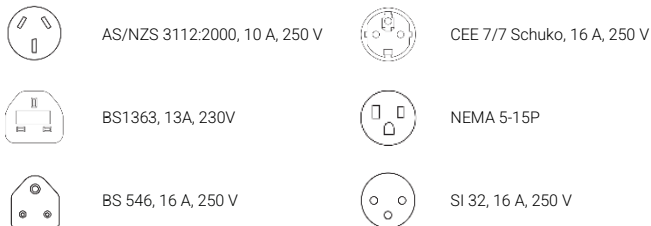

ELECTRICAL SPECIFICATIONS			
UNITED STATES/CANADA			
SASD041-4	<ul style="list-style-type: none"> 679101 (Qty 1) 679101-2 (Qty 2) 679101-3 (Qty 3) 679101-6-W (Qty 6) 	100–120 VAC, 50/60 Hz, 4 A, 400 W	NEMA 5-15P
SASD041-44	679101-4 (Qty 4)		
SASD041-45	679101-5 (Qty 5)		
UK/MIDDLE EAST			
SASD042-4	<ul style="list-style-type: none"> 679202 (Qty 1) 679202-2 (Qty 2) 	200–240 VAC, 50/60 Hz, 2 A, 400 W	BS1363, 13 A, 230 V
SASD042-43	679202-3 (Qty 3)		
SASD042-44	679202-4 (Qty 4)		
SASD042-45	679202-5 (Qty 5)		
SASD042-46	679202-6 (Qty 6)		
INTERNATIONAL			
SASD042-4	<ul style="list-style-type: none"> 679203 (Qty 1) 679203-2 (Qty 2) 	200–240 VAC, 50/60 Hz, 2 A, 400 W	CEE 7/7 Schuko, 16 A, 250 V
SASD042-43	679203-3 (Qty 3)		
SASD042-44	679203-4 (Qty 4)		
SASD042-45	679203-5 (Qty 5)		
SASD042-46	679203-6 (Qty 6)		
AUSTRALIA			
SASD042-4	<ul style="list-style-type: none"> 679204 (Qty 1) 679204-2 (Qty 2) 	200–240 VAC, 50/60 Hz, 2 A, 400 W	AS/NZS 3112:2000, 10 A, 250 V
SASD042-43	679204-3 (Qty 3)		

ELECTRICAL SPECIFICATIONS			
SASD042-44	679204-4 (Qty 4)		
SASD042-45	679204-5 (Qty 5)		
SASD042-46	679204-6 (Qty 6)		
SOUTH AFRICA			
SASD042-4	<ul style="list-style-type: none"> 679207 (Qty 1) 679207-2 (Qty 2) 	200–240 VAC, 50/60 Hz, 2 A, 400 W	BS 546, 16 A, 250 V
SASD042-43	679207-3 (Qty 3)		
SASD042-44	679207-4 (Qty 4)		
SASD042-45	679207-5 (Qty 5)		
SASD042-46	679207-6 (Qty 6)		
ISRAEL			
SASD042-4	<ul style="list-style-type: none"> 679208 (Qty 1) 679208-2 (Qty 2) 	200–240 VAC, 50/60 Hz, 2 A, 400 W	SI 32, 16 A, 250 V
SASD042-43	679208-3 (Qty 3)		
SASD042-44	679208-4 (Qty 4)		
SASD042-45	679208-5 (Qty 5)		
SASD042-46	679208-6 (Qty 6)		