

# INCOGNEETO™

INVISIBLE UNDER-COUNTER WARMER



## PERFORMANCE

The CookTek® Incogneeto™ is an under-counter buffet warmer designed to mount under natural stone or “engineered” stone countertops – no cutting of the stone is required. The Magneeto™ II trivet (one included with purchase) is placed on the countertop and acts as a temperature sensor, communicator, and locator, allowing efficient heating of any induction-compatible pan through the stone countertop. \*

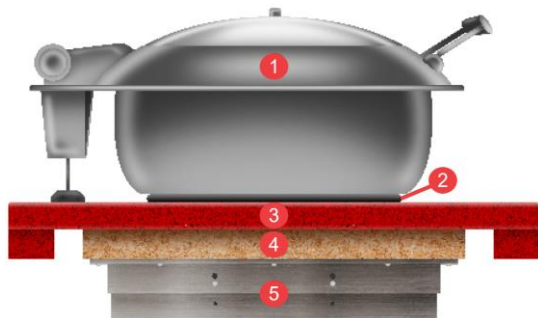

CROSS-SECTION VIEW

- |                        |                      |
|------------------------|----------------------|
| 1. Chafing Dish        | 4. Plywood Substrate |
| 2. Magneeto™ II Trivet | 5. Incogneeto™       |
| 3. Stone Countertop    |                      |

## FEATURES

- 650 W models available
- Available in 100–120 or 200–240 VAC, single phase
- Under-the-counter design with a polycarbonate top and aluminum housing
- Included Magneeto™ trivet locates heat zone when placed on the countertop
- Accommodates up to a 12” (305 mm) induction-compatible enamel cast ironware or traditional chafer
- Can be safely used under natural stone or engineered “stone” countertops
- Automatic pan detection allows for instant energy transmission to pan; almost no energy consumption when pan is not present
- Lock feature prevents unwanted setting changes

## STANDARD INCLUDED ACCESSORIES

- Magneeto™ II Trivet (#INC-3000)
- 18” mounting frame
- One-year field-service warranty (U.S. and Canada)
- 6-ft (1.8 m) nominal plug and cord
- Standard Cat 5e or Cat 6 patch cable from unit to control box



\*Induction buffet units require the use of induction-compatible (i.e. magnetic) cookware.

It is the owner and installer’s responsibility to comply with all local codes. CookTek reserves the right to make component substitutions or change specifications without prior notice.

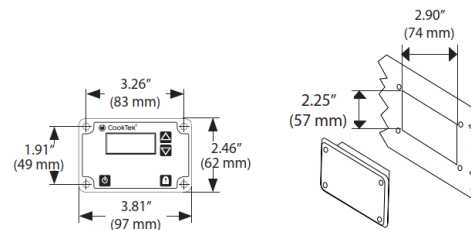
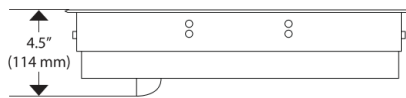
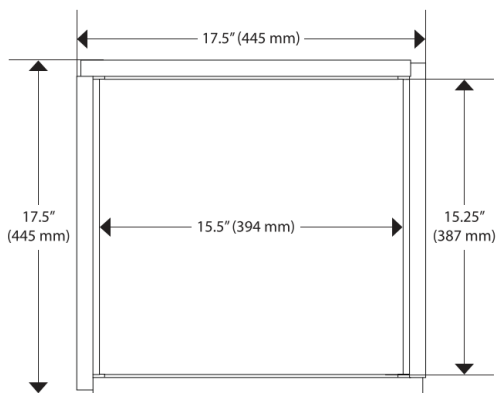

DIMENSIONS		
Height	4.5"	114 mm
Width	17.5"	445 mm
Depth	17.5"	445 mm
Interior Surface Width	15.5"	394 mm
Interior Surface Depth	15.25"	387 mm
Weight	15 lb	6.8 kg
Max Ambient Temperature	122 °F	50 °C

- AS/NZ 3112:2000, 10 A, 250 V
- BS1363, 13 A, 230 V
- BS 546, 16A, 250V
- CEE 7/7 Schuko, 16 A, 250 V
- NEMA 5-15P
- NEMA 6-20P
- SI 32, 16A, 250V

COOLING REQUIREMENTS AND SPECIFICATIONS		
Minimum Ventilation Requirements	16 in <sup>2</sup>	(103 cm <sup>2</sup> )
Internal Cooling Fan Displacement	70 CFM (2.0m <sup>3</sup> /min)	

ELECTRICAL SPECIFICATIONS MODEL: B651-U2		
UNITED STATES/CANADA		
660801	100-120 V, 50/60 Hz, 6 A, 650 W	NEMA 5-15P

CLEARANCE		
Front	2"	51 mm
Sides	2"	51 mm
Below	6"	152 mm

ELECTRICAL SPECIFICATIONS MODEL: B652-U2		
UNITED STATES/CANADA		
660901	200-240 V, 50/60 Hz, 4 A, 650 W	NEMA 6-20P
UK/MIDDLE EAST		
660902	200-240 V, 50/60 Hz, 4 A, 650 W	BS1363, 13 A, 230 V
INTERNATIONAL		
660903	200-240 V, 50/60 Hz, 4 A, 650 W	CEE 7/7 Schuko, 16 A, 250 V
AUSTRALIA		
660904	200-240 V, 50/60 Hz, 4 A, 650 W	AS/NZ 3112:2000, 10 A, 250 V
SOUTH AFRICA		
660907	200-240 V, 50/60 Hz, 4 A, 650 W	BS 546, 16A, 250V
ISRAEL		
660908	200-240 V, 50/60 Hz, 4 A, 650 W	SI 32, 16A, 250V

SHIPPING INFORMATION		
Packaged Height	10"	254 mm
Packaged Width	21"	533 mm
Packaged Depth	21"	533 mm
Packaged Weight	18 lb	8 kg
Item Class	250 NMFC #26710	

▲ Dedicated circuit required for each installation.