

DROP-IN DOUBLE HOB COOKTOP

Side-to-Side with Helios Controls



HELIOS

Helios, CookTek's new enhanced user interface, provides improved reliability and more precise cooking controls. The capacitive touch control includes power percentage or temperature display options.

FEATURES

- Models available in 5,000 (2,500/hob) and 7,000 (3,500/hob) watts
- Available in 200–240 VAC, single phase
- Drop-in design with stainless steel
- High-quality internal electronics and heavy gauge Litz wire
- Easy-to-clean high-temperature glass-ceramic top
- 4.3" capacitive touch display
- Even heat distribution across the bottom of cookware*
- Temperature range from 85°F–425°F (29°C–218°C)
- Individual controls for each hob for independent operation and functionality
- Automatic pan detection allows for instant energy transmission to pan
- Automatic shut-off feature prohibits overheating
- Integral grease filter and air baffle ensure air intake is cleaner and cooler
- Microprocessor monitors vital components to check for overheating, power supply issues, and more

INCLUDED

- Two-year advanced replacement warranty – U.S. and Canada
- Integral fan to keep internal components cool
- Standard Cat 5e or Cat 6 patch cable from the unit to the control box
- Plug and cord (6 ft. nominal)

CERTIFICATIONS



*Induction cooking requires the use of induction-compatible (i.e. magnetic) cookware.

The owner and installer are responsible for complying with all local codes. CookTek reserves the right to make substitutions of components or change specifications without prior notice.

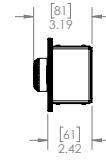
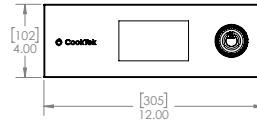
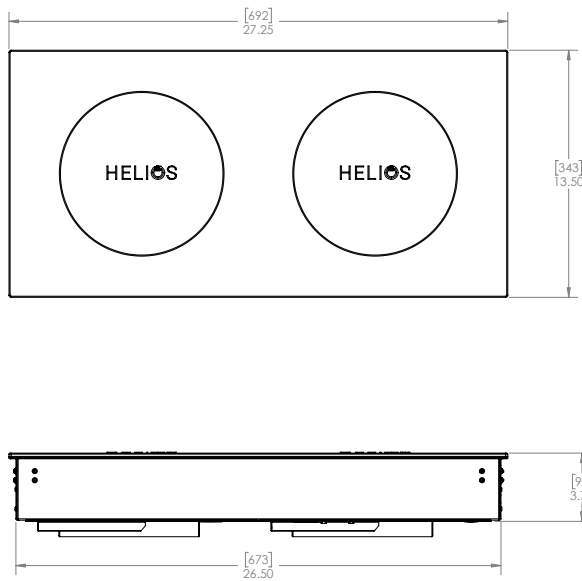

| DIMENSIONS | | |
|--|----------------------------------|---------------------|
| Height | 3.73" | 95 mm |
| Width | 27.25" | 692 mm |
| Housing Width | 26.5" | 673 mm |
| Depth | 13.5" | 343 mm |
| Housing Depth | 12.75" | 324 mm |
| Cutout Width | 26.875" | 683 mm |
| Cutout Depth | 13.125" | 333 mm |
| Weight | 30 lb. | 13.6 kg |
| CLEARANCE | | |
| Front | 2" | 51 mm |
| Sides | 2" | 51 mm |
| Rear | 2" | 51 mm |
| Below | 6" | 152 mm |
| COOLING REQUIREMENTS AND SPECIFICATIONS* | | |
| Max Ambient Temperature | 122°F | 50°C |
| Min. Ventilation Requirements | 32 in ² | 206 cm ² |
| Internal Cooling Fan Displacement | 140 CFM (4.0m ³ /min) | |
| SHIPPING INFORMATION | | |
| Packaged Height | 11" | 279 mm |
| Packaged Width | 32" | 813 mm |
| Packaged Depth | 23" | 584 mm |
| Packaged Weight | 40 lb. | 18.14 kg |
| Item Class | 250 NMFC #26710 | |

| ELECTRICAL SPECIFICATIONS (SINGLE PHASE) | | | |
|--|---|-----------------------|--|
| UNITED STATES/CANADA | | | |
| HTD-9500-SS25-1 | Drop-in, 2 hob, side-to-side, 2 x 2500W, 240V | NEMA 6-30P | |
| HTD-9500-SS35-1 | Drop-in, 2 hob, side-to-side, 2 x 3500W, 240V | NEMA 6-50P | |
| UK AND SAUDI ARABIA | | | |
| HTD-9500-SS25-2 | Drop-in, 2 hob, side-to-side, 2 x 2500W, 240V | IEC 309 32A, 3-pin | |
| HTD-9500-SS35-2 | Drop-in, 2 hob, side-to-side, 2 x 3500W, 240V | | |
| INTERNATIONAL | | | |
| HTD-9500-SS25-3 | Drop-in, 2 hob, side-to-side, 2 x 2500W, 240V | IEC 309 32A, 3-pin | |
| HTD-9500-SS35-3 | Drop-in, 2 hob, side-to-side, 2 x 3500W, 240V | | |
| AUSTRALIA | | | |
| HTD-9500-SS25-4 | Drop-in, 2 hob, side-to-side, 2 x 2500W, 240V | 56PA332 32A, 250V | |
| HTD-9500-SS35-4 | Drop-in, 2 hob, side-to-side, 2 x 3500W, 240V | | |
| JAPAN | | | |
| HTD-9500-SS25-6 | Drop-in, 2 hob, side-to-side, 2 x 2500W, 200V | Call Factory | |
| HTD-9500-SS35-6 | Drop-in, 2 hob, side-to-side, 2 x 3500W, 200V | | |
| SOUTH AFRICA | | | |
| HTD-9500-SS25-7 | Drop-in, 2 hob, side-to-side, 2 x 2500W, 240V | N/A | |
| HTD-9500-SS35-7 | Drop-in, 2 hob, side-to-side, 2 x 3500W, 240V | IEC 309 32A, 3-pin | |
| ISRAEL | | | |
| HTD-9500-SS25-8 | Drop-in, 2 hob, side-to-side, 2 x 2500W, 240V | IEC 309 32A, 3-pin | |
| HTD-9500-SS35-8 | Drop-in, 2 hob, side-to-side, 2 x 3500W, 240V | | |

* Adequate cabinet ventilation should be provided for all drop-in models to prevent overheating of unit.



Dedicated circuit required for each installation